

VG925-S | PSP™ Mount 15" Flexible Steel Gooseneck Mount for Sony PSP

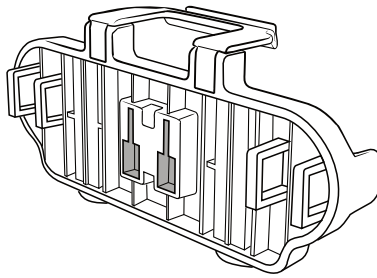

CM088-TS-2 15" Flexible Steel "Gooseneck" Mount (shown with Seat Bolt Bracket attached)



VG085 Sony PSP Cradle
For use with Sony PSP Portable game system

Package Contents:

- (1) Seat Bolt Bracket
- (1) Floor / Console Bracket
- (1) Flexible Steel Shaft with Plastic Tubing
- (1) Dual T-tab Pattern Head
- (3) Screws
- (4) Plastic Caps
- (1) VG085 Sony PSP Cradle

NOTES:

1. Tool for Seat Bolt mounting - socket wrench
2. Tools for optional Floor or Console mounting - drill and screwdriver
3. Do not twist the cradle or device while mounted on top of the pedestal to adjust the steel shaft as this can break the dual T-slots.

Installation Instructions

Passenger Seat Bolt Mounting

For a simple mount that can be easily moved to another vehicle, install using the passenger seat bolt (no drilling required).

- Step 1. Screw the flexible steel shaft into the Seat Bolt Bracket.

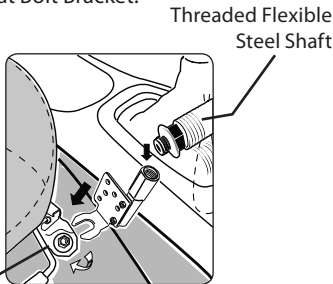

Seat Bolt Bracket

- Step 2. With a socket wrench, loosen the passenger seat bolt, insert the Seat Bolt Bracket, and retighten the seat bolt.



Safety Precautions

Drilling onto the floor or console can permanently damage the vehicle. Use caution and consult a mobile install professional to avoid drilling into the gas tank, electrical system or other highly sensitive vehicle components.

Arkon Resources, Inc. is not responsible for any damages caused to your car or yourself due to the install of the pedestal mount.

Floor or Console Mounting

For a more permanent mount, connect the Floor / Console Mount Bracket to the floor or console. This will require drilling into your vehicle's interior surface.

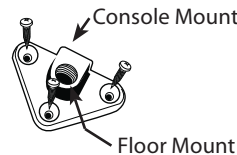

Floor Mount

- Step 1. Position the Floor / Console Bracket and drill into the floor or console.

- Step 2. Attach the Floor / Console Bracket with screws and cover with plastic caps.

- Step 3. Screw the steel shaft into the Floor / Console Bracket.

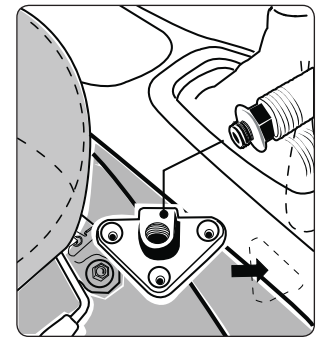

Pedestal Head Adjustments

- Step 1. Adjust the steel shaft by bending with both hands to the desired location of the Dual T-tab head.

- Step 2. Use the adjustment knob (A) and wing nut (B) on the pedestal head to swivel or rotate the head position if necessary.

- Step 3. Align the female dual T-slots on the cradle to the dual T-tabs on the pedestal head. Insert device.

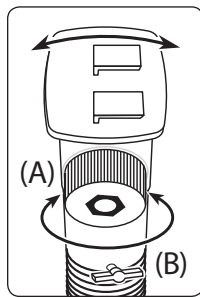

Connecting the cradle

Slide the T-slots of the cradle onto the T-tabs of the mount head.

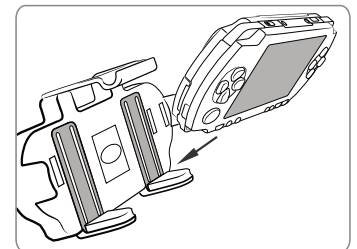
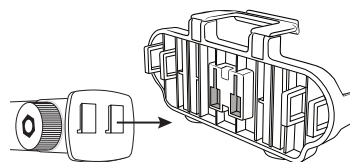

Sony PSP Cradle Instructions

- Step 1. Insert PSP into the cradle at a slant so that the base of the PSP comes to rest on the spring loaded support legs.

- Step 2. While firmly holding the cradle, push downward on the PSP so that the spring loaded support legs slide down. This allows enough clearance for the top of the PSP to slide under the top support clip.



Safety Precautions

Drilling onto the floor or console can permanently damage the vehicle. Use caution and consult a mobile install professional to avoid drilling into the gas tank, electrical system or other highly sensitive vehicle components.

Arkon Resources, Inc. is not responsible for any damages caused to your vehicle, your device, or yourself due to the installation or use of this product.

ARKON
RESOURCES INC.

The Mobile Mounting Specialists™

Consumer Hotline:
(USA) (800) 841-0884
(INT'L) (626) 254-9005

Mon-Fri. 9am-5pm, PST

www.arkon.com
Arcadia, CA 91006 USA
Made in Taiwan

© Copyright 2007 Arkon Resources, Inc.