

# TTOXL129-ST-RVC | Removable Vent Mount with Swivel for TomTom™ ONE® XL

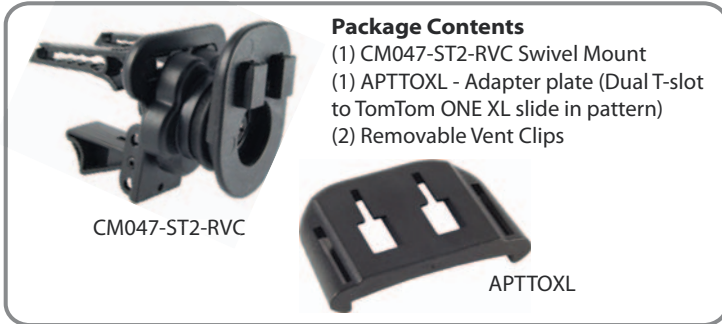

## Package Contents

- (1) CM047-ST2-RVC Swivel Mount
- (1) APTTOXL - Adapter plate (Dual T-slot to TomTom ONE XL slide in pattern)
- (2) Removable Vent Clips

## Pedestal Adjustment & Device Cradle Installation

Step 1. Adjust the swivel angle of the pedestal head by firmly holding the back of the pedestal (B), loosening the swivel tightening ring (D) and adjusting to the desired angle. When the unit is in position, retighten the swivel tightening ring to secure.



Use caution when inserting, adjusting and removing the swivel pedestal to avoid damaging your air vents. When removing the TomTom ONE XL from pedestal, hold the pedestal firmly with one hand and use your free hand to disengage it from the pedestal.

Step 2. Attach the device cradle to the pedestal by inserting the dual T-Tabs of the pedestal (E) into the T-slots of the cradle (F).

## Pedestal Assembly

Step 1. Attach the vent mounting clips (A) to the back of the pedestal (B) with the vent clips positioned with the flat sides facing up.

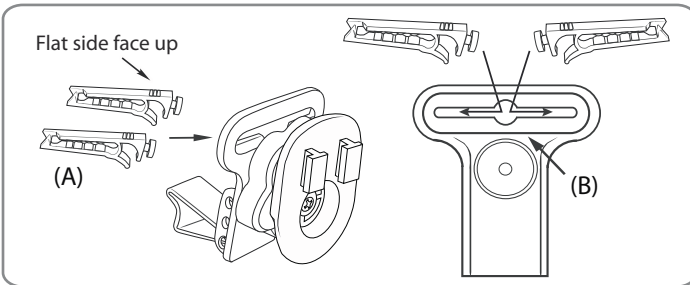

## Insertion of Pedestal into the Air Vent

Step 1. Pinch the vent mounting clips (A) so that the teeth open and gently insert vent pedestal into vent louvres until the mounting clips are attached to the fin/blade of the vent. Adjust the support leg (C) vertically until it rests firmly along the bottom of the vent or dash surface below the vent.

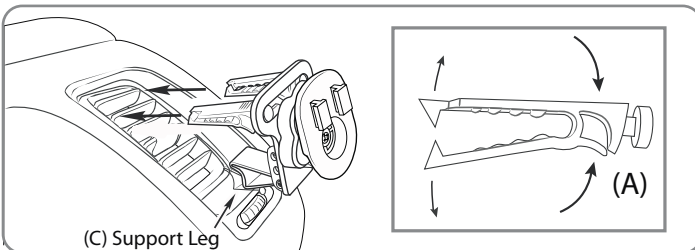

2. Attach the adapter plate (A) into the grooves on the back of the TomTom One XL GPS device (B).

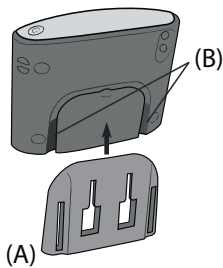

## Safety Precautions

Do not install Arkon products over an air bag cover or within the air bag deployment zone. Arkon Resources, Inc. assumes no responsibility of liability for injury or death as a result of car crashes and/or air bag deployment.

Arkon Resources, Inc. is not responsible for any damages caused to your air vent louvres, car, device, or yourself as a result of the installation or use of this mount.

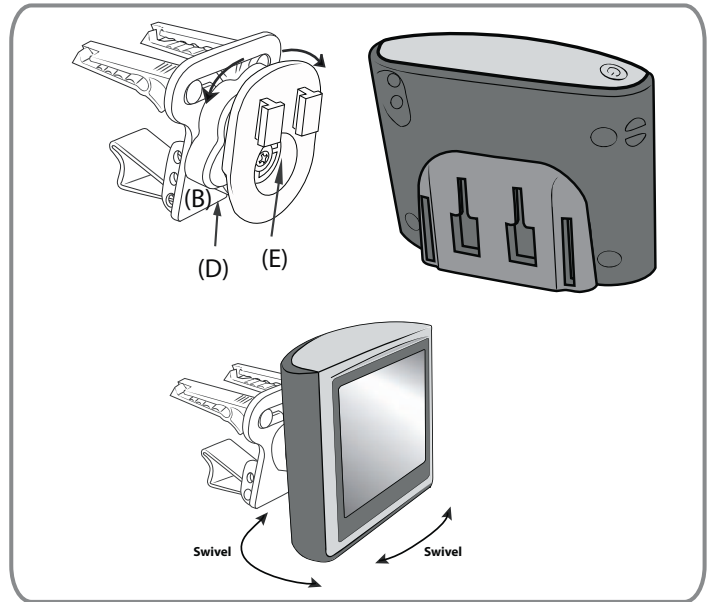

## Pedestal Removal

Step 1. Remove the device from the vent mount assembly.

Step 2. Pinch the vent clips (A) so that the teeth open.

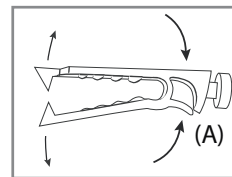

Step 3. Carefully slide the pedestal from the vent/blade. Make sure the teeth of the vent clips are open enough so as not to damage the vent.

**ARKON**  
RESOURCES INC.

The Mobile Mounting Specialists™

Consumer Hotline:  
(USA) (800) 841-0884  
(INT'L) (626) 254-9005  
Mon-Fri. 9am-5pm, PST

[www.arkon.com](http://www.arkon.com)  
Arcadia, CA 91006 USA  
Made in Taiwan

© Copyright 2007 Arkon Resources, Inc.