

TTOXL112 | Friction Dashboard Mount for TomTom One XL



Package Contents:

- (1) CM012 - Weighted "friction style" dashboard mount
- (1) GN014-SBH - Suction pedestal with swivel ball head
- (1) Optional adhesive safety hook (recommended but not required)
- (1) APTTOXL - Adapter plate for TomTom ONE XL and XL•S (1st Edition)
- (1) Alcohol cleaning pad

TomTom Device Compatibility:

- For use with TomTom ONE XL and ONE XL•S 1st Editions
- Adapter plate **NOT** compatible with TomTom ONE XL 30 Series (also known as TomTom ONE XL and XL•S 2nd Edition)

TomTom and ONE XL are product names, trademarks, or registered trademarks of TomTom International BV. Arkon Resources, Inc. is not affiliated with TomTom International BV.

⚠ Do not place mount in or near an air bag deployment zone or where it will obstruct view of the road.

Dashboard Mount Installation

Step 1. Find a safe location on the vehicle dashboard that is not in an airbag deployment zone.



Step 2. **Optional Safety hook installation will add extra stability.** Clean the desired area with the included alcohol pad and let dry. Remove the adhesive backing on the safety anchor. The hook on the anchor must point towards the windshield. Press and hold the hook down on to the dashboard surface for about a minute. Allow 24 hrs. to cure to the dashboard surface at room temperature (72° F.)

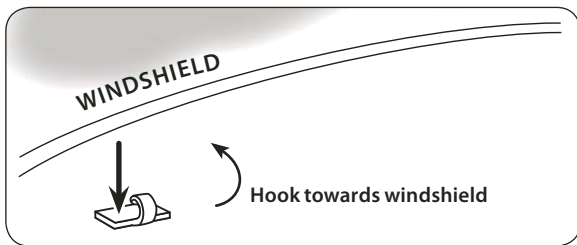

Step 3. Place the loop on the back of the dashboard mount around the safety hook and place on the dashboard in front of the hook.

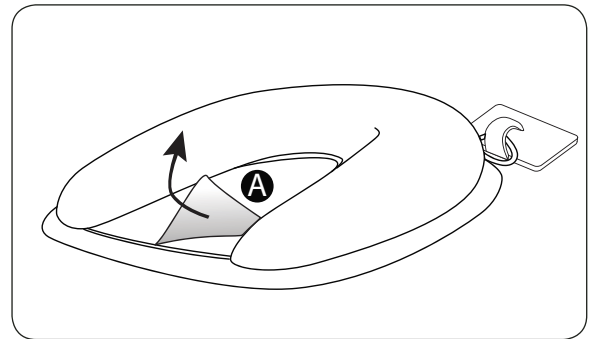

Step 4. Remove protective film from pedestal mounting surface (A). Lower the pedestal onto the disc and press down firmly. Flip the locking lever down to secure the pedestal to the dash mount.

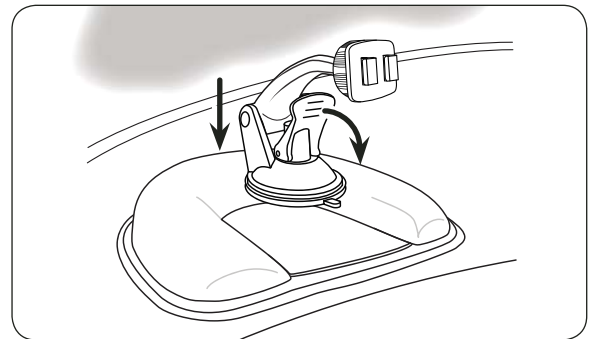

Continued on other side...

⚠ Safety Precautions
Do not install Arkon products over an air bag cover or within the air bag deployment zone. Arkon Resources, Inc. assumes no responsibility of liability for injury or death as a result of car crashes and/or air bag deployment.

Arkon is not responsible for any damages caused to your car, your device, or yourself due to the installation or use of this pedestal mount.

ARKON
RESOURCES INC. *The Mobile Mounting Specialists™*

Consumer Hotline:
USA (800) 841-0884
INT'L (626) 254-9005
Monday - Friday 9am - 5pm, PST

www.arkon.com
Arcadia, CA 91006 USA
Designed in USA | Made in China
© Copyright 2010 Arkon Resources, Inc.

Dashboard Mount Installation - Continued

Step 5. Adjust the angle of the pedestal arm by tightening the rotation knob.

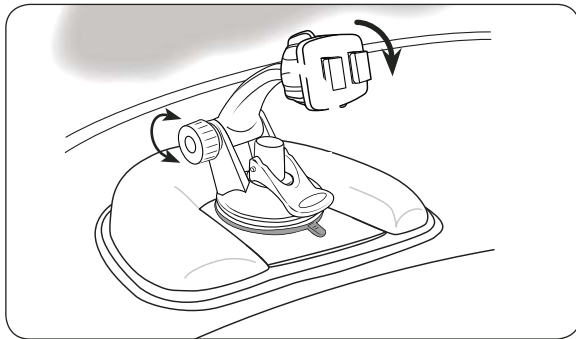

Step 6. Adjust the angle of the pedestal head by tightening the head adjustment knob.

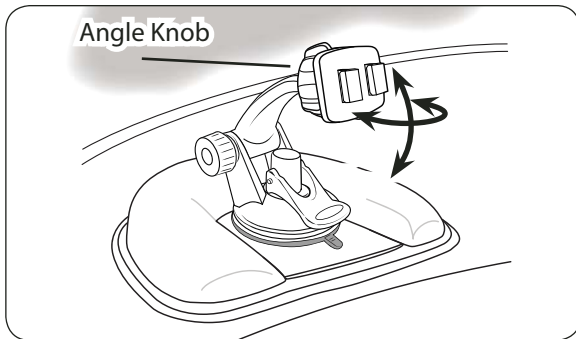

TomTom ONE XL and ONE XL•S Adapter Plate Installation

Step 1. Slide the adapter plate up into the grooves on the back of the TomTom ONE XL or ONE XL•S device (sold separately).

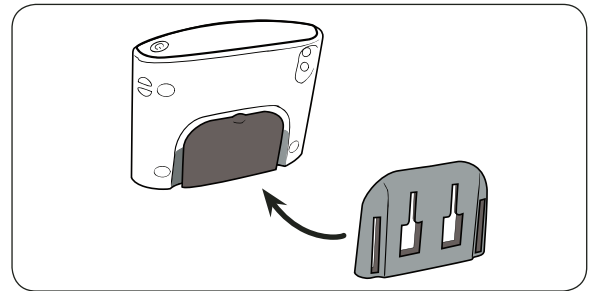

TomTom ONE XL / XL•S Device Installation - Pedestal Attachment

Step 1. Attach the device to the pedestal by inserting the dual T-Tabs of the pedestal into the T-slots of the TomTom adapter plate. Readjust angle knobs if necessary.

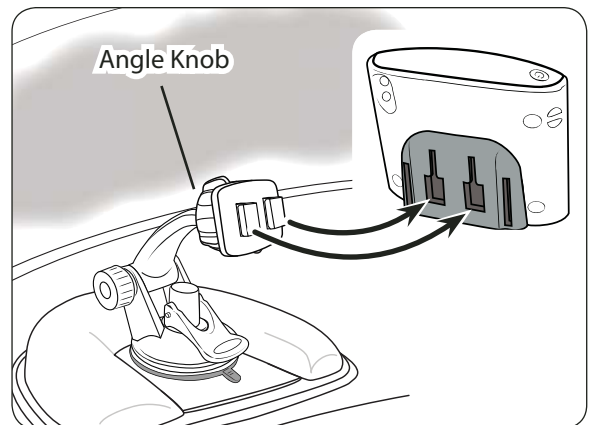

Safety Precautions

Do not install Arkon products over an air bag cover or within the air bag deployment zone. Arkon Resources, Inc. assumes no responsibility of liability for injury or death as a result of car crashes and/or air bag deployment.

Arkon is not responsible for any damages caused to your car, your device, or yourself due to the installation or use of this pedestal mount.

ARKON
RESOURCES INC.

The Mobile Mounting Specialists™

Consumer Hotline:

USA (800) 841-0884

INT'L (626) 254-9005

Monday - Friday 9am - 5pm, PST

www.arkon.com

Arcadia, CA 91006 USA

Designed in USA | Made in China

© Copyright 2010 Arkon Resources, Inc.