

TTOXL111 | Sun Visor Mount for TomTom ONE XL / XL•S GPS



Package Contents:

- (1) CM011-2 - Sun visor mount
- (1) APTTO - Adapter plate for TomTom ONE XL and XL•S

Compatible with TomTom devices:

- TomTom ONE XL / XL•S - 1st, 2nd, & 3rd Editions

⚠ Note: Arkon strongly recommends using the visor mount on the passenger side sun visor. Using this mount on the driver's side visor will reduce the driver's view of the road.

Do not place device car charger cords in or near an air bag deployment zone.

TomTom brand name and ONE product names are trademarks or registered trademarks of TomTom NV. Arkon Resources, Inc. is not affiliated with TomTom NV.

Sun Visor Mounting

- Step 1. Lower the passenger side sun visor and place the clip mount over the top of the visor. Slide the mount left or right to adjust the location on the visor.

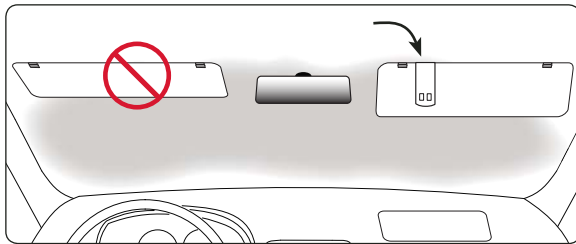

TomTom ONE XL / XL•S Adapter Plate Installation

- Step 1. Slide the adapter plate up into the grooves on the back of the TomTom ONE XL / XL•S device. (Not included, sold separately.)

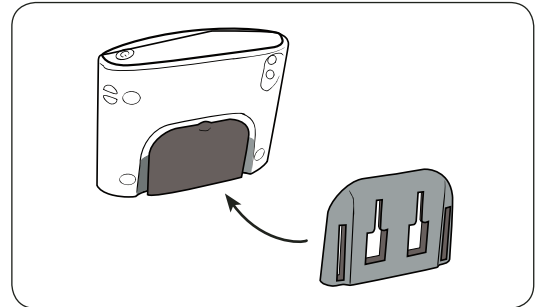

TomTom Device Attachment

- Step 1. Attach the device cradle to the visor mount by inserting the dual T-Tabs of the mount (A) into the T-slots of the adapter plate (B). Finish by connecting the car charger cord from the 12V lighter socket up to your TomTom device. (Not included, sold separately.)

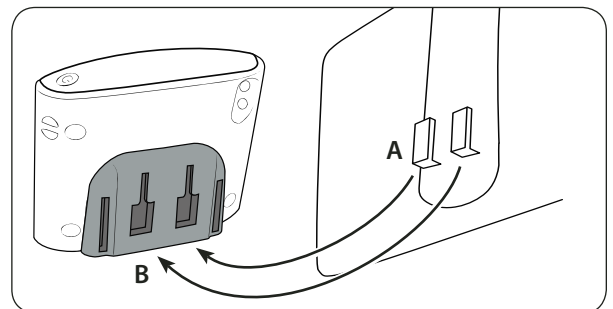

Safety Precautions

Follow all manufacturer safety guidelines for operating your device. Failure to practice safe usage of GPS device while driving may result in damage, injury, or death.

Arkon is not responsible for any damages caused to your car, your device, or yourself due to the installation or use of this pedestal mount.

ARKON
RESOURCES INC.

The Mobile Mounting Specialists™

Consumer Hotline:

USA (800) 841-0884

INT'L (626) 254-9005

Monday - Friday 9 am - 5 pm, PST

www.arkon.com

Arcadia, CA 91006 USA

Designed in USA | Made in China

© Copyright 2008 Arkon Resources, Inc.