

TTEP128 | 1" Multi Angle Dash or Console Mount for TomTom® EasyPort™



Package Contents:

- (1) CM048-2 - 1" Multi angle adhesive dash mount
- (3) Self tapping screws (optional)
- (1) APTTEP - Adapter plate for TomTom EasyPort pattern
- (1) Alcohol cleaning pad

Compatible with:

- TomTom ONE 130, TomTom ONE 130-S
- TomTom XL 330, TomTom XL 330-S
- TomTom ONE 22, ONE 22 Europe, ONE Regional (NEW)
- TomTom XL Europe 22, XL Europe 22 Traffic
- TomTom XL Regional, TomTom XL Regional Traffic

! Do not place mount in or near an air bag deployment zone or where it will obstruct view of the road.

Drilling into the dash, floor, or console will permanently damage the vehicle. Use caution and consult a mobile install professional to avoid drilling into the gas tank, electrical system or other highly sensitive vehicle components.

Dash or Console Adhesive Mounting

- Step 1. Find a safe location on the dash or console to mount the pedestal. Make sure the area is clean and dry. Use the included alcohol pad to clean the mounting surface.

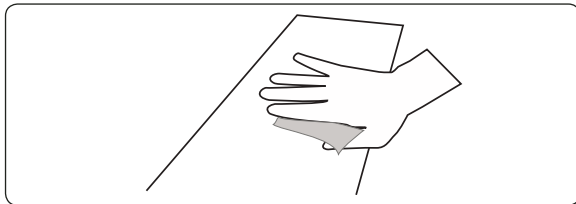

- Step 2. Remove the adhesive backing (A) under the triangular pedestal and firmly press into place.

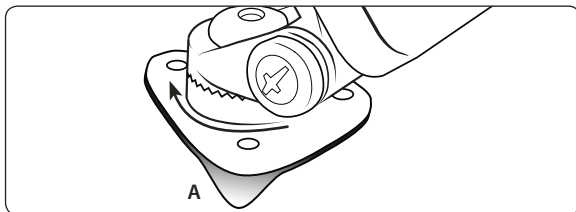

- Step 3. After adhesive has bonded at room temperature (approx. 72° F), allow 24 hours prior to use for best results.
- Step 4. Adjust the angle of the pedestal head by firmly holding the base and rotating to the desired angle.

Dash or Console Screw Mounting (Optional)

- Step 1. Find a safe location on the dash or console to mount the pedestal. Make sure the area is clean and dry. Use the included alcohol pad to clean the mounting surface. Remove the adhesive backing (A) under the triangular pedestal and firmly press into place.
- Step 2. Using a screwdriver, tighten the 3 screws (B) through the pedestal base into the mounting surface. Adjust the angle of the pedestal head by firmly holding the base and rotating to the desired angle.

Continued on next column...

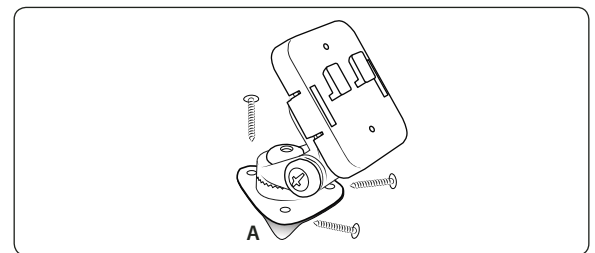

Adapter Plate Connection and Device Insertion and Removal

- Step 1. Connect the dual T-slots (C) on the back of the adapter plate to the dual T-tabs (D) on the dash pedestal head.

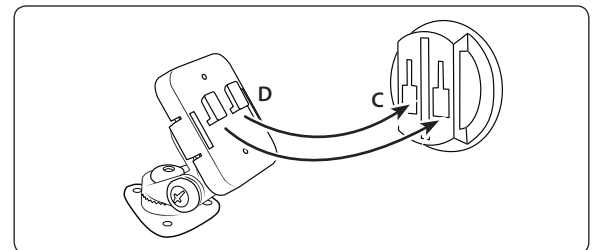

- Step 2. While holding the mounted adapter plate, gently insert the device (not included, sold separately) into the adapter plate until an audible click is heard. The device can then be rotated into the desired viewing angle.

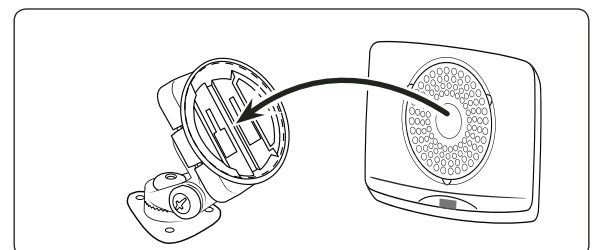

TomTom brand name and product names are trademarks, or registered trademarks of TomTom International NV. Arkon Resources, Inc. is not affiliated with TomTom International NV.

! Safety Precautions

Do not install Arkon products over an air bag cover or within the air bag deployment zone. Arkon Resources, Inc. assumes no responsibility of liability for injury or death as a result of car crashes and/or air bag deployment.

Arkon is not responsible for any damages caused to your car, your device, or yourself due to the installation or use of this pedestal mount.

ARKON
RESOURCES INC.

The Mobile Mounting Specialists™

Consumer Hotline:

USA (800) 841-0884

INT'L (626) 254-9005

Monday - Friday 9 am - 5 pm, PST

www.arkon.com

Arcadia, CA 91006 USA

Designed in USA | Made in China and Taiwan

© Copyright 2008 Arkon Resources, Inc.