

TTEP125 | Flexible Gooseneck Seat Bolt or Floor Mount for TomTom® EasyPort™



CM088-TS-2
15" Flexible Floor Mount

Patent Pending

APTTEP
Adapter Plate
for EasyPort

Package Contents:

- (1) CM088-TS-2 - 15" Flexible steel gooseneck floor or console mount
Includes: (1) Seat Bolt Bracket, (1) Floor / Console Bracket, (4) Screws, (4) Plastic Caps, and (1) Flexible Steel Shaft with Plastic Tubing
- (1) APTTEP - Adapter plate for TomTom EasyPort pattern

Required Tools for Installation:

1. Socket wrench
2. Drill and screwdriver for optional floor or console mounting

Compatible with:

- TomTom ONE** 125, 125-SE, ONE 130, ONE 130-S, 140, ONE 140-S
- TomTom XL** 325, XL 325-S, XL 325-SE, XL 330, XL 330-S, XL 335 Series, XL 340, XL 340-S, XL 340 LIVE Series, XL 350 Series
- TomTom XXL** 530-S, XXL 535-T, XXL 540-S/WTE, XXL 550 Series
- TomTom PRO** 4000, TomTom PRO 8000
- TomTom ONE** 22, ONE 22 Europe, ONE Europe 22 Assist, TomTom ONE Regional, ONE Regional Assist
- TomTom Europe** 22, XL Regional Assist, XL Europe 22 Traffic,
- TomTom XL** Regional, XL Regional Traffic



Do not place mount in or near an air bag deployment zone or where it will obstruct view of the road.

1 Passenger Seat Bolt Mounting

For a simple mount that can be easily moved to another vehicle, install using the passenger seat track bolt.

- Step 1. Screw the flexible steel shaft into the seat track bolt bracket.
- Step 2. With a socket wrench, loosen the passenger seat track bolt, insert the seat track bolt bracket, and retighten the seat track bolt.

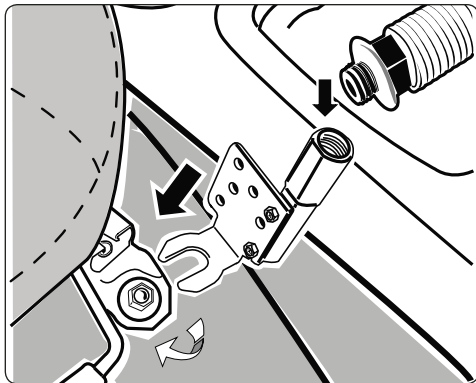

2 Floor or Console Mounting

For a more permanent mount, connect the Floor / Console Mount Bracket to the floor or console. This will require drilling into your vehicle's interior surface.



Drilling into the dash, floor, or console will permanently damage the vehicle. Use caution and consult a mobile install professional to avoid drilling into the gas tank, electrical system or other highly sensitive vehicle components.

Continued on next column...

TomTom, ONE, GO, and EasyPort, Start and Ease are product names, trademarks, or registered trademarks of TomTom International b.v. Arkon Resources, Inc. is not affiliated with TomTom International b.v.



Safety Precautions

Do not install Arkon products over an air bag cover or within the air bag deployment zone. Arkon Resources, Inc. assumes no responsibility of liability for injury or death as a result of car crashes and / or air bag deployment.

Arkon is not responsible for any damages caused to your car, your device, or yourself due to the installation or use of this pedestal mount.

- Step 1. Position the Floor / Console Bracket and drill into the floor or console.
- Step 2. Attach the Floor / Console Bracket with screws and cover with plastic caps.
- Step 3. Screw the steel shaft into the Floor / Console Bracket.

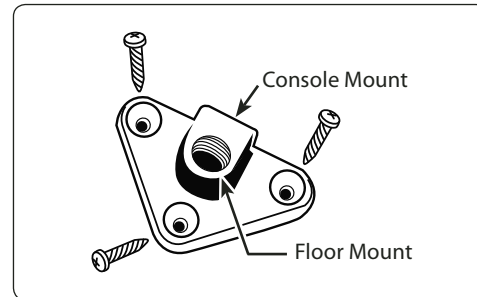

3 Pedestal Head Adjustments

- Step 1. Adjust the steel shaft by bending with both hands to the desired location of the male dual T head.

Use the adjustment knob and wing nut on the pedestal

- Step 2. head to swivel or rotate the head position if necessary.

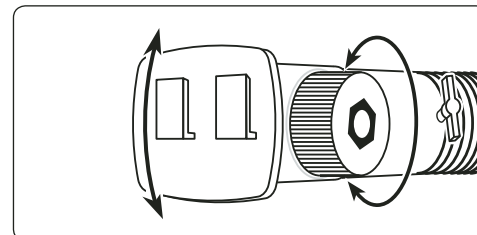

Continued on other side...

ARKON
RESOURCES INC.

The Mobile Mounting Specialists™

Consumer Hotline:

USA (800) 841-0884

INT'L (626) 254-9005

Monday - Friday 9am - 5pm, PST

www.arkon.com

Arcadia, CA 91006 USA

Designed in USA | Made in China and Taiwan

© Copyright 2008 Arkon Resources, Inc.

4 Adapter Plate Connection and Device Insertion and Removal

Step 1. Connect the dual T-slots (A) on the back of the adapter plate to the dual T-tabs (B) on the mount pedestal head.

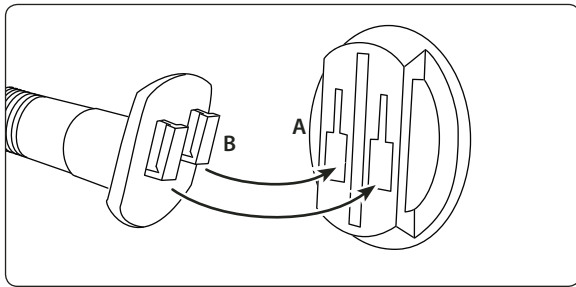

Step 2. While holding the mounted adapter plate, gently insert the device (not included, sold separately) into the adapter plate until an audible click is heard. The device can then be rotated into the desired viewing angle.

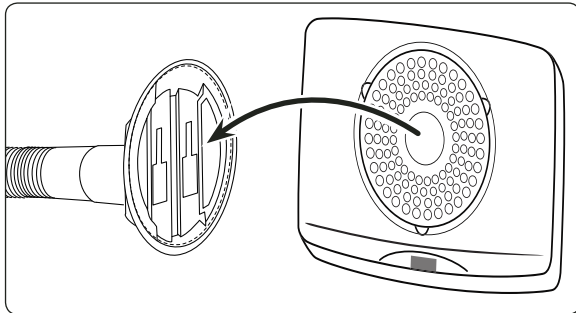

TomTom brand name and product names are trademarks, or registered trademarks of TomTom International NV. Arkon Resources, Inc. is not affiliated with TomTom International NV.



Safety Precautions

Do not install Arkon products over an air bag cover or within the air bag deployment zone. Arkon Resources, Inc. assumes no responsibility of liability for injury or death as a result of car crashes and /or air bag deployment.

Arkon is not responsible for any damages caused to your car, your device, or yourself due to the installation or use of this pedestal mount.



The Mobile Mounting Specialists™

Consumer Hotline:

USA (800) 841-0884

INT'L (626) 254-9005

Monday - Friday 9 am - 5 pm, PST

www.arkon.com

Arcadia, CA 91006 USA

Designed in USA | Made in China and Taiwan

© Copyright 2008 Arkon Resources, Inc.