

# SM416 | Mini Adhesive Dashboard, Removable Desktop, or Screw Mount

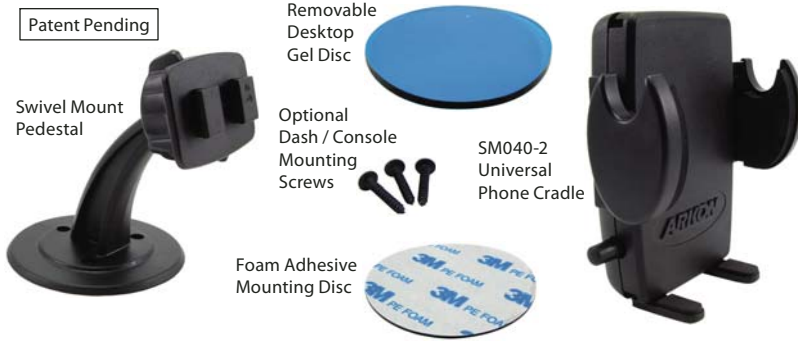

## Package Contents:

- (1) SM040-2 - Universal phone cradle
- (1) GN016-SBH - Swivel mount pedestal
- (1) Semi-permanent foam adhesive disc (optional)
- (1) Removable desktop gel disc (optional)
- (1) Set of 3 mounting screws (optional)
- (1) Alcohol cleaning pad

**!** Do not place mount in or near an air bag deployment zone or where it will obstruct view of the road.

## Desktop Mount Installation

- Step 1. Clean the desk or other smooth surface area and let dry.
- Step 2. Remove the backing on one side of the gel disc and place the sticky side down on the cleaned surface. Press the top of the disc down firmly to allow the gel to stick to the surface.

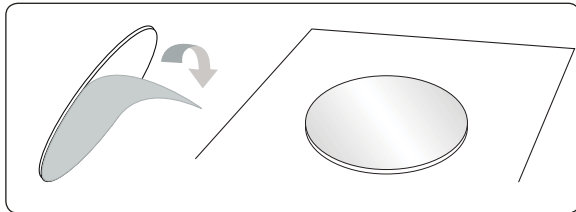

- Step 2. Remove the backing on the top side of the gel disc and firmly press the pedestal down on the adhesive disc.

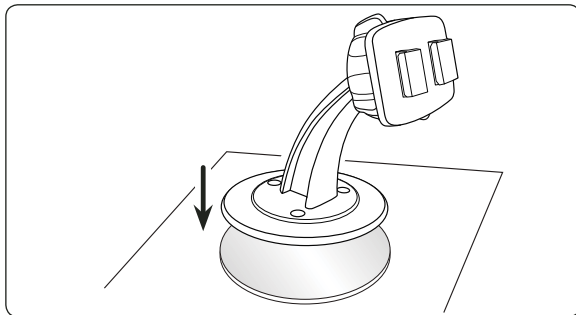

- Step 3. To remove the desktop gel disc, simply peel and lift up. Clean the disc with soap and water to revive the gel's stickiness.

## Vehicle Dash or Console Mount Installation

- Step 1. Find a safe location on the vehicle dash or console. Clean the dash or console surface area thoroughly with the included alcohol pad. Allow the area dry before applying the disc.

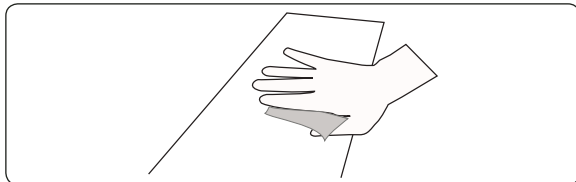

- Step 2. Remove the paper backing on one side of the disc and place the sticky side down on the cleaned surface. Press the top of the disc down firmly to allow the adhesive to stick to the surface. Allow 24 hours for the adhesive to cure to the surface before attaching the mount.

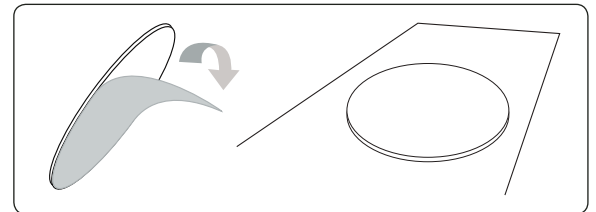

- Step 3. Remove the paper on the top side and firmly press the mount down on the adhesive disc.

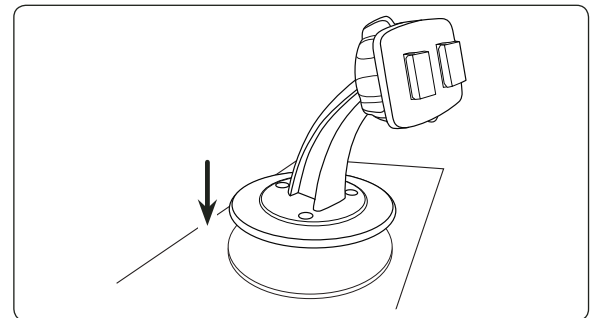

## Optional Screw Mounting



### Safety Precautions

Drilling into the dash or console is a permanent installation to the vehicle. Use caution and consult a mobile install professional to avoid drilling into the gas tank, electrical system or other highly sensitive vehicle components.

Arkon Resources, Inc. is not responsible for any damages caused to your car or yourself due to the install of the pedestal mount.

*Continued on other side...*



### Safety Precautions

Do not install Arkon products over an air bag cover or within the air bag deployment zone. Arkon Resources, Inc. assumes no responsibility of liability for injury or death as a result of car crashes and/or air bag deployment.

Arkon is not responsible for any damages caused to your car, your device, or yourself due to the installation or use of this pedestal mount.

**ARKON**<sup>®</sup>  
RESOURCES INC.

*The Mobile Mounting Specialists™*

Consumer Hotline:

USA (800) 841-0884

INT'L (626) 254-9005

Monday - Friday 9am - 5pm, PST

[www.arkon.com](http://www.arkon.com)

Arcadia, CA 91006 USA

Designed in USA | Made in China and Taiwan

© Copyright 2010 Arkon Resources, Inc.

Continued from previous side...

- Step 1. Using a screwdriver, tighten the 3 screws (A) through the pedestal base holes (B) into the mounting surface.

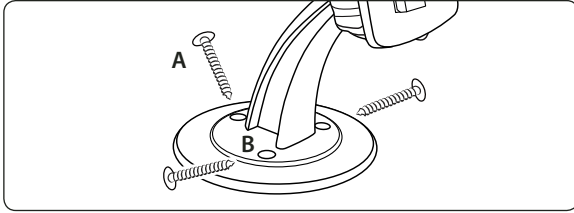

## Connect Universal Cradle to Pedestal

- Step 1. While holding the pedestal, firmly slide the dual T-slots (C) on the back of the universal cradle to the dual T-tabs (D) of the pedestal head. Adjust the angle of the pedestal head and tighten the adjustment ring (E).

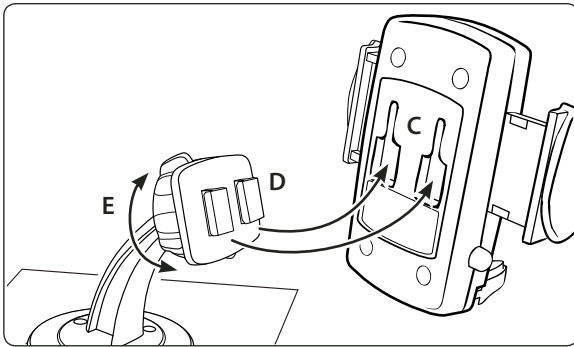

## Device Insertion and Removal from Cradle

- Step 1. Place the phone or device into the cradle with the device sitting on the support legs (F). Clamp the grip arms (G) inward to firmly grasp the device. Press the release button (H) to open the arms.

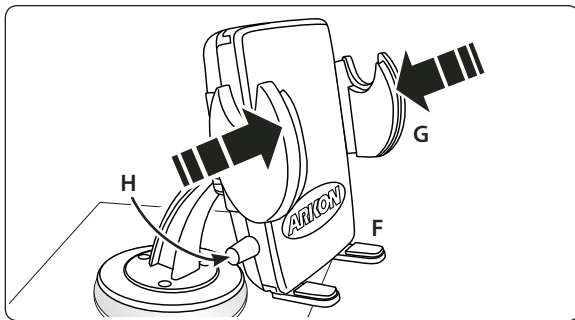

## Universal Cradle Adjustments

- Step 1. If necessary, adjust the removable support legs by sliding them laterally on top or bottom of the cradle. These will provide added support and stability for your device.

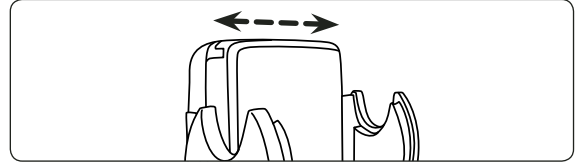

### Safety Precautions

Do not install Arkon products over an air bag cover or within the air bag deployment zone. Arkon Resources, Inc. assumes no responsibility of liability for injury or death as a result of car crashes and/or air bag deployment.

Arkon is not responsible for any damages caused to your car, your device, or yourself due to the installation or use of this pedestal mount.

**ARKON**<sup>®</sup>  
**RESOURCES INC.**

*The Mobile Mounting Specialists™*

Consumer Hotline:

USA (800) 841-0884

INT'L (626) 254-9005

Monday - Friday 9am - 5pm, PST

[www.arkon.com](http://www.arkon.com)

Arcadia, CA 91006 USA

Designed in USA | Made in China and Taiwan

© Copyright 2010 Arkon Resources, Inc.