

# MM329-ST | Removable Air Vent Mount for Mio Moov 300 / Navman S50 3D GPS



## Package Contents:

- (1) CM047-ST2-RVC - Removable swivel air vent mount assembly
- (1) APMM300 - Adapter plate for Mio Moov 300 pattern

## Compatible with:

- Mio Moov Mio Moov 300, 301, 310, 330, 330 Europe, 360, 370 Europe, 380, 500, and Knight Rider GPS Edition
- Navman S50, S50 3D, S70, S90i

**!** Use caution when adjusting the swivel movement to avoid damaging your air vents.

All brand names and product names are trademarks or registered trademarks of their respective owners.

## Air Vent Mount Assembly

- Step 1. Attach the vent mounting clips (A) to the back of the pedestal (B) with the vent clips positioned with the flat sides facing up.

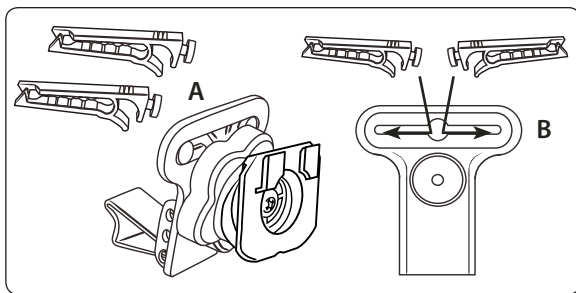

## Connect Power Cord to Adapter Plate

- Step 1. Insert the power cord (not included, sold separately) into the grooved slot in the bottom of the adapter plate.

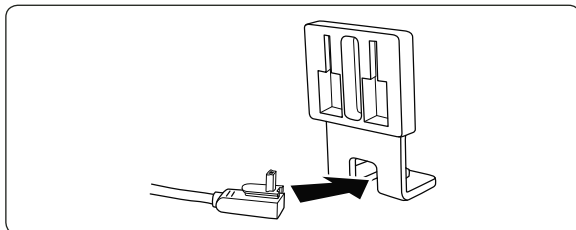

## Connect Adapter Plate to Device

- Step 1. Insert the adapter plate with power cord into the vertical groove pattern on the back of the GPS device (not included, sold separately.)

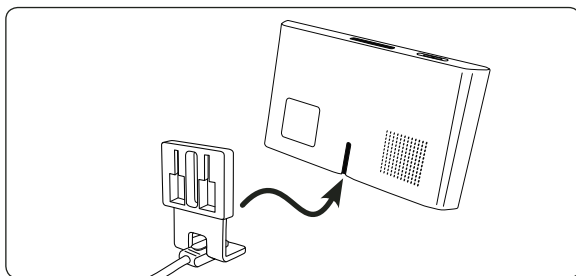

## Air Vent Mount Installation

- Step 1. Pinch the vent mounting clips (A) so that the teeth open and gently insert vent pedestal into vent louvres until the mounting clips are attached to the fin/blade of the vent. Adjust the support leg (C) vertically until it rests firmly along the bottom of the vent or dash surface below the vent.

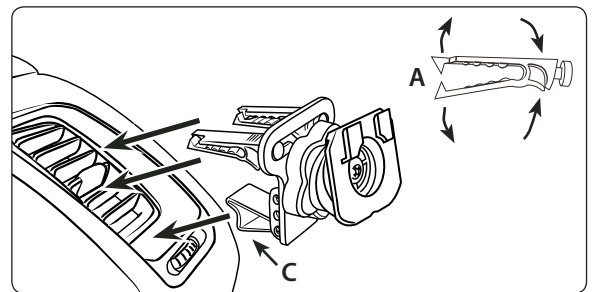

**!** Use caution when adjusting or removing the pedestal. Make sure that the teeth of the vent clips are opened wide enough to not damage vent.

## GPS Device Attachment

- Step 1. Attach the device to the air vent mount by inserting the dual T-Tabs of the pedestal (D) into the T-slots of the device (E).

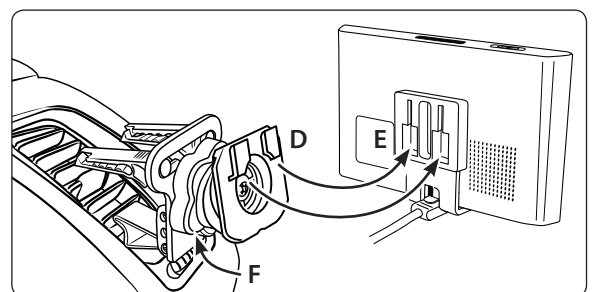

- Step 2. Adjust the lateral angle and the rotation of the pedestal head by loosening the swivel tightening ring (F).

**!** **Safety Precautions**  
Follow all manufacturer safety guidelines for operating your device. Failure to practice safe usage of GPS device while driving may result in damage, injury, or death. Do not install Arkon products over an air bag cover or within the air bag deployment zone.  
Arkon is not responsible for any damages caused to your car, your device, or yourself due to the installation or use of this pedestal mount.

**ARKON**  
**RESOURCES INC.** The Mobile Mounting Specialists™

Consumer Hotline:

USA (800) 841-0884

INT'L (626) 254-9005

Monday - Friday 9 am - 5 pm, PST

[www.arkon.com](http://www.arkon.com)

Arcadia, CA 91006 USA

Designed in USA | Made in Taiwan

© Copyright 2008 Arkon Resources, Inc.