

# MM229-ST | Removable Air Vent Mount for Mio Moov 200 / Navman S30 3D GPS



## Package Contents:

- (1) CM047-ST2-RVC - Removable swivel air vent mount assembly
- (1) APMM200 - Adapter plate for Mio Moov and Navman S30 3D

No tools required for installation.

## Compatible with:

- Mio Moov - 200 Series
- Navman - S30 and S30 3D GPS models

**!** Use caution when adjusting the swivel movement to avoid damaging your air vents.

All brand names and product names are trademarks or registered trademarks of their respective owners.

## Installation Instructions

### Air Vent Mount Assembly, Plate Attachment, and Installation

Step 1. Attach the vent mounting clips (A) to the back of the pedestal (B) with the vent clips positioned with the flat sides facing up.

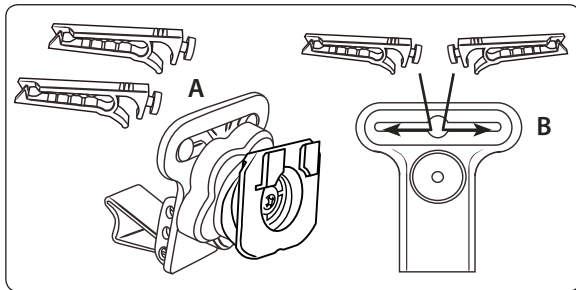

Step 2. Attach the dual T-tabs (C) on the pedestal into the dual T-slots (D) on the back of the adapter plate.

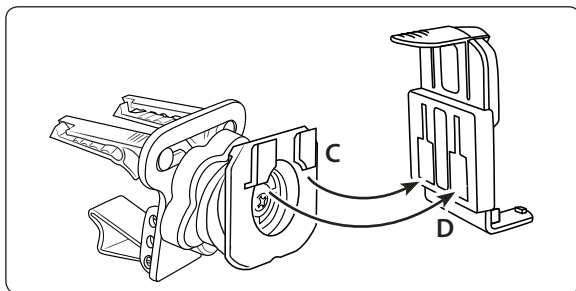

Step 3. Pinch the vent mounting clips (A) so that the teeth open and gently insert vent pedestal into vent louvres until the mounting clips are attached to the fin/blade of the vent. Adjust the support leg (E) vertically until it rests firmly along the bottom of the vent or dash surface below the vent.

*Continued on next column...*

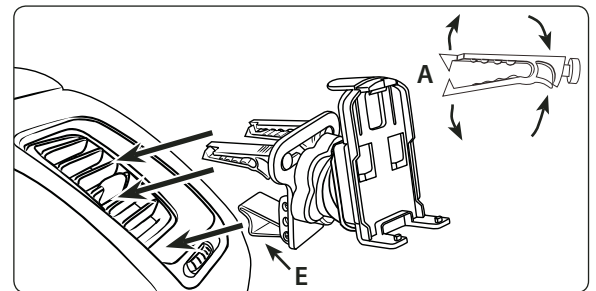

### GPS Device Attachment

Step 1. With the air vent pedestal installed, attach the GPS device (not included, sold separately) by placing the feet (F) of the adapter into the corresponding notches on the bottom of the device. Holding the thumb tab down, insert the upper tooth (G) into the recessed slot on the back of the device.

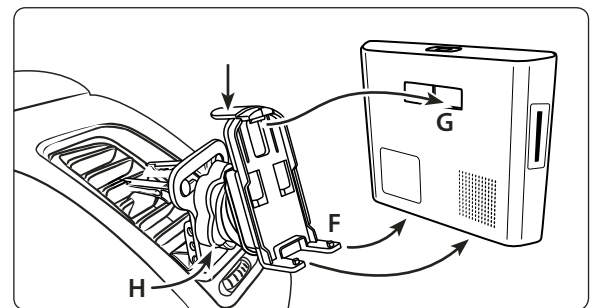

Step 2. Adjust the lateral angle and the rotation of the pedestal head by loosening the swivel tightening ring (H).

**!** Use caution when adjusting or removing the pedestal. Make sure that the teeth of the vent clips are opened wide enough to not damage vent.

**!** **Safety Precautions**  
Follow all manufacturer safety guidelines for operating your device. Failure to practice safe usage of GPS device while driving may result in damage, injury, or death. Do not install Arkon products over an air bag cover or within the air bag deployment zone.

Arkon is not responsible for any damages caused to your car, your device, or yourself due to the installation or use of this pedestal mount.

**ARKON**  
**RESOURCES INC.** The Mobile Mounting Specialists™

Consumer Hotline:

USA (800) 841-0884

INT'L (626) 254-9005

Monday - Friday 9 am - 5 pm, PST

[www.arkon.com](http://www.arkon.com)

Arcadia, CA 91006 USA

Made in Taiwan

© Copyright 2008 Arkon Resources, Inc.