

MM225 | Seat Bolt or Floor Mount for Mio® Moov™ 200 Series / Navman S30 3D



Package Contents:

- (1) CM088-TS-2 - 15" Flexible steel gooseneck floor or console mount
- Includes: (1) Seat Bolt Bracket, (1) Floor / Console Bracket, (4) Screws, (4) Plastic Caps, and (1) Flexible Steel Shaft with Plastic Tubing
- (1) APMM200 - Dual-T to Mio Moov 200 pattern adapter plate

Required Tools for Installation:

1. Socket wrench
2. Drill and screwdriver for optional floor or console mounting

Compatible with:

- Mio Moov 200 Series
- Navman S30 3D GPS

All brand names and product names are trademarks or registered trademarks of their respective owners.

! Do not place mount in or near an air bag deployment zone or where it will obstruct view of the road.

1 Passenger Seat Bolt Mounting

For a simple mount that can be easily moved to another vehicle, install using the passenger seat track bolt.

- Step 1. Screw the flexible steel shaft into the seat track bolt bracket.
- Step 2. With a socket wrench, loosen the passenger seat track bolt, insert the seat track bolt bracket, and retighten the seat track bolt.

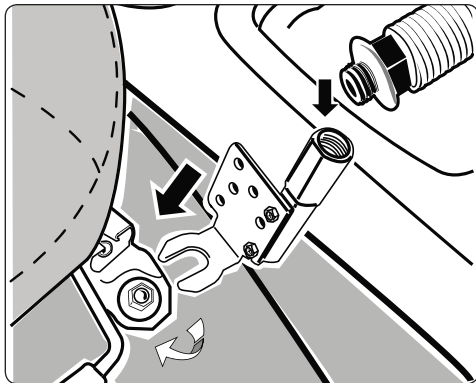

2 Floor or Console Mounting

For a more permanent mount, connect the Floor / Console Mount Bracket to the floor or console. This will require drilling into your vehicle's interior surface.

- !** Drilling into the dash, floor, or console will permanently damage the vehicle. Use caution and consult a mobile install professional to avoid drilling into the gas tank, electrical system or other highly sensitive vehicle components.

Continued on next column...

! Safety Precautions

Do not install Arkon products over an air bag cover or within the air bag deployment zone. Arkon Resources, Inc. assumes no responsibility of liability for injury or death as a result of car crashes and/or air bag deployment.

Arkon is not responsible for any damages caused to your car, your device, or yourself due to the installation or use of this pedestal mount.

- Step 1. Position the Floor / Console Bracket and drill into the floor or console.
- Step 2. Attach the Floor / Console Bracket with screws and cover with plastic caps.
- Step 3. Screw the steel shaft into the Floor / Console Bracket.

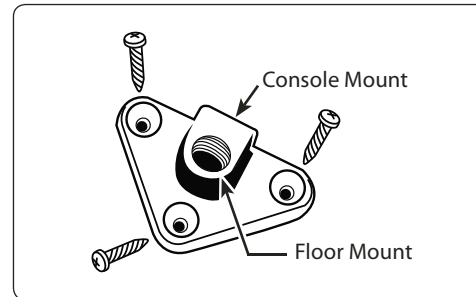

3 Pedestal Head Adjustments

- Step 1. Adjust the steel shaft by bending with both hands to the desired location of the male dual T head.
- Step 2. Use the adjustment knob and wing nut on the pedestal head to swivel or rotate the head position if necessary.

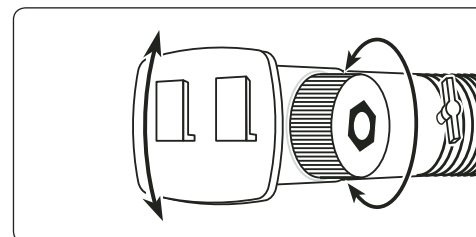

Continued on other side...

ARKON
RESOURCES INC.

The Mobile Mounting Specialists™

Consumer Hotline:

USA (800) 841-0884

INT'L (626) 254-9005

Monday - Friday 9 am - 5 pm, PST

www.arkon.com

Arcadia, CA 91006 USA

Designed in USA | Made in China and Taiwan

© Copyright 2008 Arkon Resources, Inc.

4 Connect Adapter Plate to Mio Moov 200 Series Device

Step 1. Connect the Moov adapter plate to Moov 200 device (not included, sold separately) by placing the feet (A) of the adapter into the corresponding notches (B) on the bottom of the device. Holding the thumb tab down (C), insert the upper tooth (D) into the recessed slot on the back of the device.

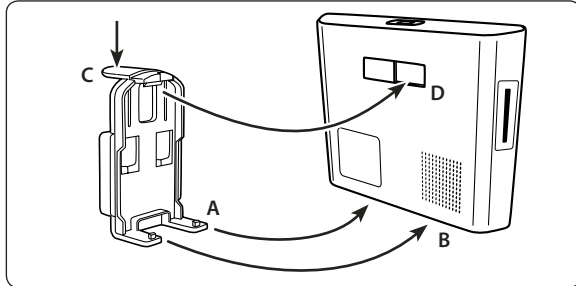

Connect Mio 200 Series Device to Floor Mount

Step 1. Attach the device to the pedestal by inserting the dual T-Tabs on the pedestal head (E) into the T-slots on the adapter plate (F).

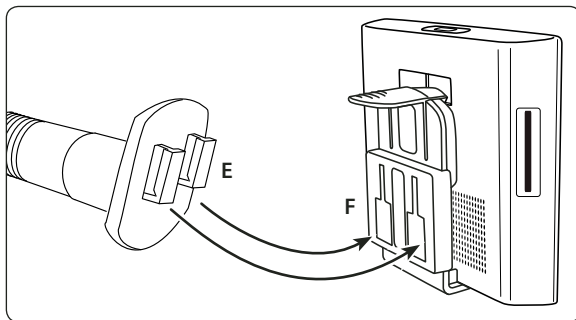

Safety Precautions

Do not install Arkon products over an air bag cover or within the air bag deployment zone. Arkon Resources, Inc. assumes no responsibility of liability for injury or death as a result of car crashes and /or air bag deployment.

Arkon is not responsible for any damages caused to your car, your device, or yourself due to the installation or use of this pedestal mount.

ARKON
RESOURCES INC.

The Mobile Mounting Specialists™

Consumer Hotline:

USA (800) 841-0884

INT'L (626) 254-9005

Monday - Friday 9 am - 5 pm, PST

www.arkon.com

Arcadia, CA 91006 USA

Designed in USA | Made in China and Taiwan

© Copyright 2008 Arkon Resources, Inc.