

LMC220 | Laptop Mobile Connect Mount with Universal Mobile Cradle



Package Contents:

- (1) LMC200 - Laptop Mobile Connect mount with Dual-T Pattern
- (1) SM020-2 - Universal mobile cradle for mobile phones

No tools required for installation.

Laptop Mount Installation

- Step 1. Lift open the screen to your laptop computer.
- Step 2. Hold the laptop mount with both hands and squeeze both spring-loaded clasps (A) forward until fully opened.

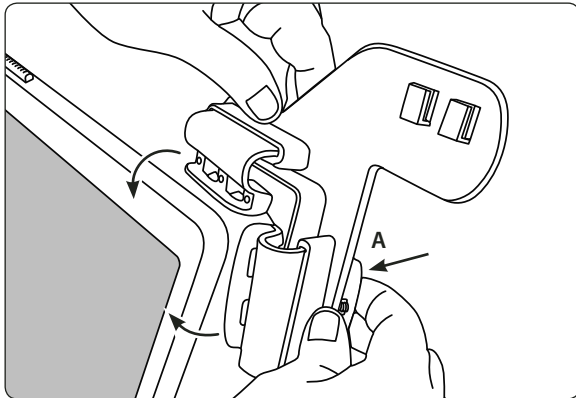

- Step 3. Slide the mount over the **upper right corner** of the laptop's screen and release the clasps. The mounting pads (B) should rest on the frame edge of the laptop's screen and **not** on the screen itself. Adjust the mount until the laptop screen is located squarely in the corner.

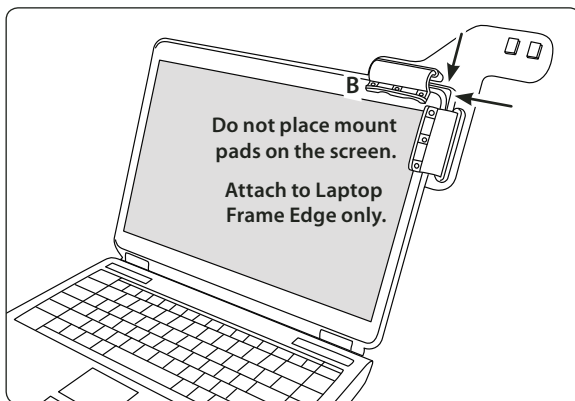

Universal Cradle Attachment

- Step 1. Attach the cradle to the mount by inserting the dual T-tabs (C) on the mount into the dual T-slots (D) on the back of the cradle.

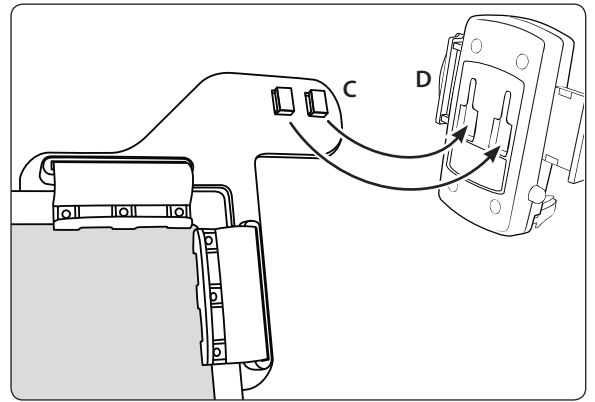

Phone Insertion and Universal Cradle Adjustment

- Step 1. Adjust the support legs (E) by sliding them laterally. Place phone on the support legs and squeeze the side grip arms (F) until they hold the phone securely.
- Step 2. Push the release button (G) in order to release the phone from the cradle.

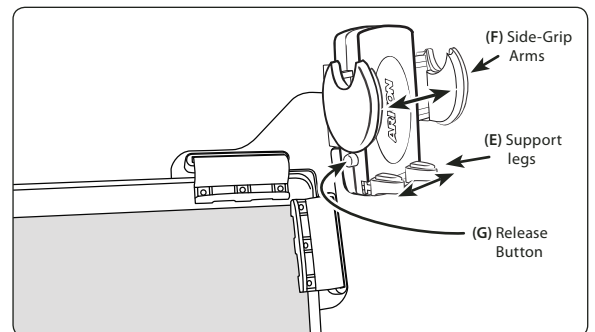

Note:

Arkon is not responsible for any damages caused to your laptop computer, your device, or yourself due to the installation or use of this laptop mount.

ARKON
RESOURCES INC.

The Mobile Mounting Specialists™

Consumer Hotline:

USA (800) 841-0884

INT'L (626) 254-9005

Monday - Friday 9 am - 5 pm, PST

www.arkon.com

Arcadia, CA 91006 USA

Designed and Made in USA

© Copyright 2009 Arkon Resources, Inc.