

IPM128 | 1" Multi Angle Dash or Console Mount for Apple® iPhone™



Package Contents:

- (1) CM048-2 - 1" Multi angle adhesive dash mount
- (3) Self tapping screws (optional)
- (1) CC005-IP - Custom cradle for Apple iPhone
- (1) Alcohol cleaning pad

Compatible with:

- Apple iPhone 3G and Original iPhone

! Do not place mount in or near an air bag deployment zone or where it will obstruct view of the road.

Drilling into the dash, floor, or console will permanently damage the vehicle. Use caution and consult a mobile install professional to avoid drilling into the gas tank, electrical system or other highly sensitive vehicle components.

Dash or Console Adhesive Mounting

- Step 1. Find a safe location on the dash or console to mount the pedestal. Make sure the area is clean and dry. Use the included alcohol pad to clean the mounting surface.

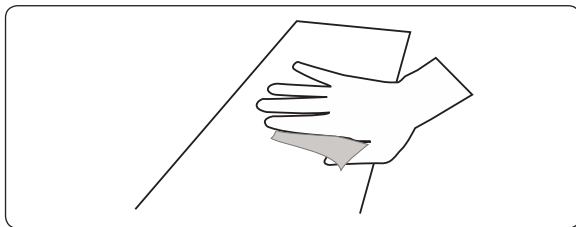

- Step 2. Remove the adhesive backing (A) under the triangular pedestal and firmly press into place.

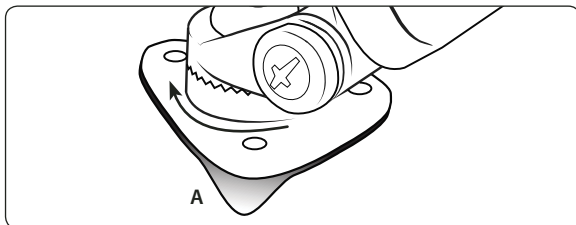

- Step 3. After adhesive has bonded at room temperature (approx. 72° F), allow 24 hours prior to use for best results.
- Step 4. Adjust the angle of the pedestal head by firmly holding the base and rotating to the desired angle.

Dash or Console Screw Mounting (Optional)

- Step 1. Find a safe location on the dash or console to mount the pedestal. Make sure the area is clean and dry. Use the included alcohol pad to clean the mounting surface. Remove the adhesive backing (A) under the triangular pedestal and firmly press into place.

Continued on next column...

Apple brand name and iPhone product name are trademarks or registered trademarks of Apple, Inc. Arkon Resources, Inc. is not affiliated with Apple, Inc.

! Safety Precautions

Do not install Arkon products over an air bag cover or within the air bag deployment zone. Arkon Resources, Inc. assumes no responsibility of liability for injury or death as a result of car crashes and/or air bag deployment.

Arkon is not responsible for any damages caused to your car, your device, or yourself due to the installation or use of this pedestal mount.

- Step 2. Using a screwdriver, tighten the 3 screws (B) through the pedestal base into the mounting surface. Adjust the angle of the pedestal head by firmly holding the base and rotating to the desired angle.

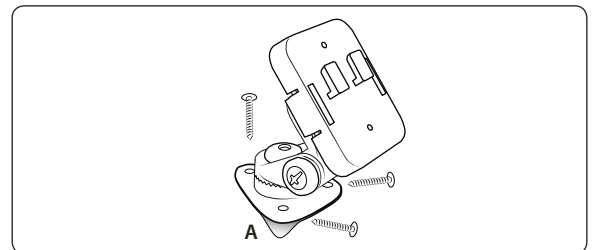

Cradle Connection and iPhone Insertion / Removal from Cradle

- Step 1. Connect the dual T-slots (C) on the back of the iPhone cradle to the dual T-tabs (D) on the air vent pedestal head.

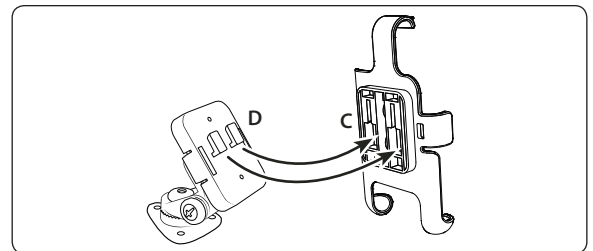

- Step 2. Lift and hold the upper thumb tab (E) while gently lowering the iPhone device (not included, sold separately) into the cradle.

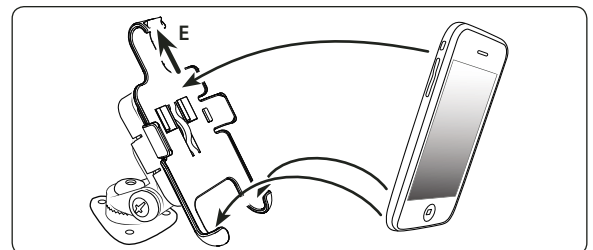

ARKON
RESOURCES INC.

The Mobile Mounting Specialists™

Consumer Hotline:
USA (800) 841-0884
INT'L (626) 254-9005
Monday - Friday 9 am - 5 pm, PST

www.arkon.com
Arcadia, CA 91006 USA
Designed in USA | Made in China and Taiwan
© Copyright 2008 Arkon Resources, Inc.