

PTM136 & BBP136 | Flexible Steel Swivel Dash or Console Mount



Compatibility: (not complete)

-Palm Treo 650	-HP iPAQ 6815	-XDA Atom Exec
-Palm Treo 680	-HP iPAQ 6818	-Dopod 818 Pro
-Palm Treo 700W	-HP iPAQ 6828	-Dopod 810
-Palm Treo 700P	-HTC P3600	-i-Mate JAMin
-Palm Treo 750	-HTC Neo	



Compatibility:

- Blackberry Pearl 8100

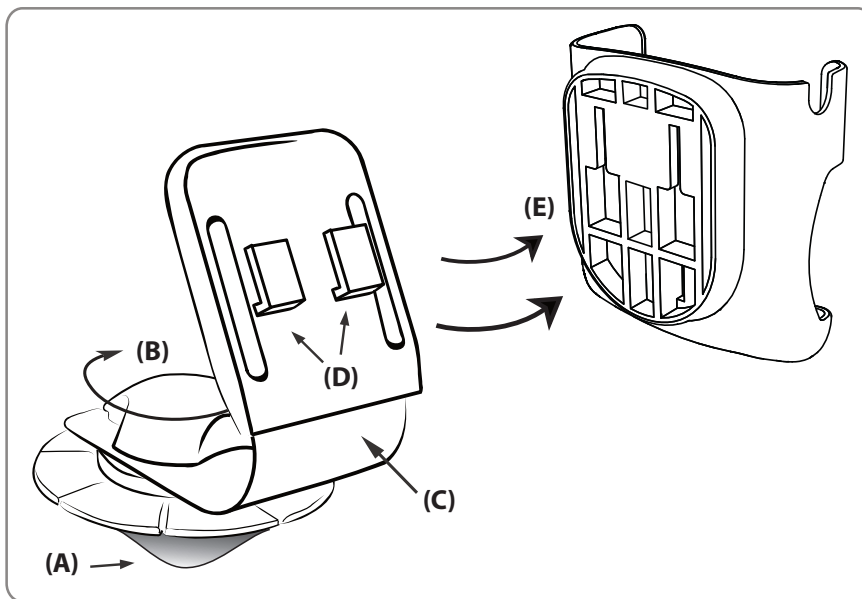

Installation Instructions

- Step 1. Find a safe location on the dash or console to mount the pedestal. Make sure the area is clean and dry. Use the included alcohol pad to clean the mounting surface. Remove the adhesive backing (A) under the circular base and firmly press into place.
- Step 2. After adhesive has bonded at room temperature (approx. 72°F) allow 24hrs prior to use for best results.

- Step 3. Adjust the direction of the pedestal by rotating the head on the swivel base (B).
- Step 4. Adjust the angle of the pedestal head by bending the flexible metal strip (C).
- Step 5. Attach the device cradle to the pedestal by inserting the dual T-tabs (D) of the pedestal into the T-slots of the cradle (E).

Safety Precautions

Do not install Arkon products over an air bag cover or within the air bag deployment zone. Arkon Resources, Inc. assumes no responsibility of liability for injury or death as a result of car crashes and/or air bag deployment.

Arkon Resources, Inc. is not responsible for any damages caused to your car, your device, or yourself due to the installation or use of the pedestal mount.

ARKON
RESOURCES INC.

The Mobile Mounting Specialists™

Consumer Hotline:
(USA) (800) 841-0884
(INT'L) (626) 254-9005
Mon-Fri. 9am-5pm, PST

www.arkon.com
Arcadia, CA 91006 USA
Made in Taiwan

© Copyright 2007 Arkon Resources, Inc.