

BBBOLD129-SBH | Air Vent Swivel Mount for BlackBerry® Bold™ 9000



GN047-SBH
Air Vent Mount with
Swivel Ball Head Assembly

CC007-BOLD
Custom Cradle
for BlackBerry Bold

Patent Pending

Package Contents:

- (1) GN047 - Air vent mount with (2) semi-removable vent clips
- (1) CC007-BOLD - Custom cradle for BlackBerry Bold
- (1) Swivel ball head (SBH) assembly with dual T-tab pattern adapter plate and tightening ring.

Compatible with:

- BlackBerry Bold 9000 smartphone



Do not place mount in or near an air bag deployment zone or where it will obstruct view of the road.

Air Vent Mount Assembly

Step 1. Attach the vent mounting clips (A) to the back of the pedestal (B) with the vent clips positioned with the flat sides facing up.

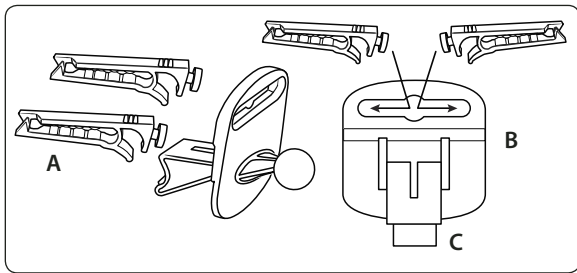

Swivel Ball Head Assembly Attachment

Step 1. Slip the tightening ring (D) over the air vent mount ball. Snap the dual-T head adapter plate (E) on to the mounting ball (F). Screw the tightening ring over the adapter plate until securely holding the plate. Swivel to adjust the angle of the dual-T head.

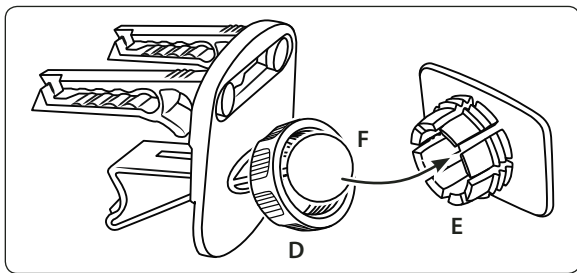

Bold Cradle Attachment to Air Vent Mount and Bold Insertion

Step 1. Attach the dual T-slots (G) on the back of the Bold cradle to the dual T-tabs (H) on the swivel mount head.

Continued on next column...

BlackBerry brand name and Bold product name are trademarks or registered trademarks of Research in Motion, Ltd. Arkon Resources, Inc. is not affiliated with Research in Motion, Ltd.



Safety Precautions

Follow all manufacturer safety guidelines for operating your device. Failure to practice safe usage of GPS device while driving may result in damage, injury, or death.

Arkon is not responsible for any damages caused to your car, your device, or yourself due to the installation or use of this pedestal mount.

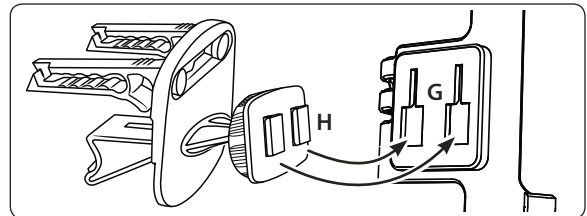

Step 2. Push and hold the right thumb tab (I) and gently insert the Bold device (not included, sold separately) into the cradle.

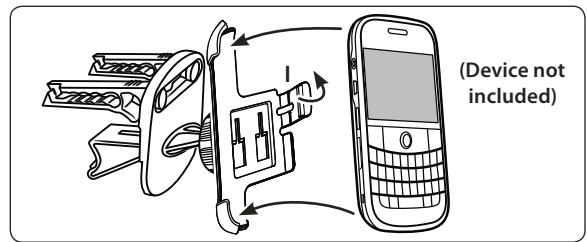

Insertion of Mount Assembly and Bold into Air Vent

Step 1. Pinch the vent mounting clips (A) so that the teeth open and gently insert vent pedestal into vent louvres until the mounting clips are attached to the fin/blade of the vent. Adjust the support leg (C) vertically until it rests firmly along the bottom of the vent or dash surface below the vent.

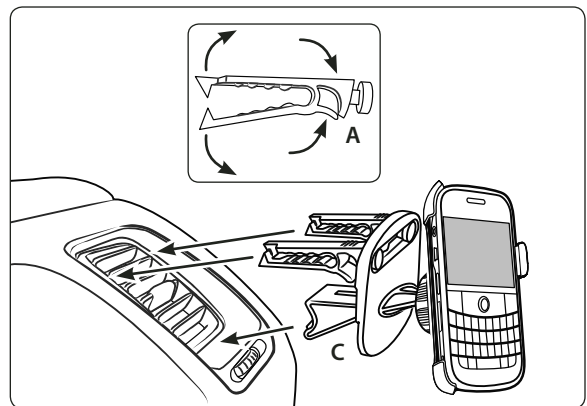

ARKON
RESOURCES INC. The Mobile Mounting Specialists™

Consumer Hotline:
USA (800) 841-0884
INT'L (626) 254-9005
Monday - Friday 9 am - 5 pm, PST

www.arkon.com
Arcadia, CA 91006 USA

Designed in USA | Made in Taiwan
© Copyright 2009 Arkon Resources, Inc.